



Consulting Engineers & Planners



ARCHITECTURE & BUILDING SERVICES DIVISION

NEWPLAN's Architectural and Engineering team has for over 14 years met and exceeded our clients' needs with innovative and excellent functional design and execution.

We are constantly evolving our skill base, reflecting the diversity and dynamism of our clients and team, and providing comprehensive quality assured services.

This brochure captures a selected range of projects that **NEWPLAN** Limited has been or is engaged in providing consultancy services from feasibility studies, through design to management of construction.

NEWPLAN Limited invites you to join our satisfied clientele to engage our consulting team in seeking solutions to your architectural, engineering and environmental challenges.



ARCHITECTURE

INTERIOR DESIGN

STRUCTURAL ENGINEERING

MECHANICAL ENGINEERING

ELECTRICAL ENGINEERING

LANDSCAPE DESIGN AND SURVEY

URBAN PLANNING

PROJECT MANAGEMENT

COST PLANNING AND MANAGEMENT





DESIGN & SUPERVISION OF CONSTRUCTION OF UGANDA NATIONAL ROAD AUTHORITY HEADQUARTERS (UNRAH) BUILDING

In association with NORPLAN AS, NEWPLAN Limited, was contracted to provide consultancy services for the Feasibility study, Design and supervision of construction for the new twin tower ten storey office building. *(See image above)*

The project is housed on two separate plots. The works involve demolitions and clearance of existing buildings and construction of paved car parking and reinforced concrete pedestrian bridge across Old Portbell Road.

DESIGN AND CONSTRUCTION SUPERVISION FOR THE DEPARTMENT OF FOOD SCIENCE AND TECHNOLOGY (DFST), MAKERERE UNIVERSITY, KAMPALA *As lead Consultant;*

Client: Makerere University, Kampala

The complex provides teaching, research and pilot production facilities for the Department which currently has 200 students. It was handed over on February 10th 2005. The project was able to realize a cost saving of 20 % (759 million US\$) of the original budget through proficient project/ cost management. *(See bottom cover image)*

STRUCTURE PLANS FOR LIRA MASINDI & DOKOLO

NEWPLAN was contracted by Ministry of Local Government to prepare through a consultative process Planning Area proposals, structure plans

and central area detailed plans for Lira, Masindi & Dokolo councils.

Other services provided by NEWPLAN included:

- Socioeconomic and physical environment studies.
- Land use maps Administrative Boundary and Constraints and Potential maps
- Sensitization and consultation of locals

FEASIBILITY STUDY, DESIGN & SUPERVISION OF CONSTRUCTION IN ARAPAI AGRICULTURAL COLLEGE, SOROTI

The project involved design of a teaching block, a lecture theatre hall, two laboratories, a computer room and student's hostel and staff housing.

The college has up to 300 students and over 60 buildings.



Arapai College; Student Dormitory blocks

BUGOYE HYDRO POWER PROJECT (HPP) RESETTLEMENT ACTION PLAN (RAP).

NEWPLAN was contracted by Tronder Power Limited to create and implement a resettlement action plan for the population in Kasese district affected by the establishment of the hydro plant in the area. This involved the design and construction supervision of housing in resettlement areas.



Affordable housing unit constructed for the RAP in Kasese, Bugoye HPP

REFURBISHMENT; RAILWAY STATION BLDG

NEWPLAN prepared a design proposal to revamp the interior of the Uganda Railway Station building. The building is of historical heritage implying that the external appearance is to be preserved. However, the proposal makes the interior more “user friendly” in light of current and future technological changes.

*Cover page photo: The entrance lobby / Hall
Void, perspective from Gallery >>>*



BAYLOR CHILDREN’S CLINIC CENTRE OF EXCELLENCE, MULAGO HOSPITAL KAMPALA

Image >>>>

In association with Planning & Design Consultant (Smaziland)

This project was intended to meet the ever increasing number of patients currently being handled at the Pediatrics Infectious Diseases Clinic at Mulago Hospital.

NEWPLAN was contracted to provide consultancy services in structural design and construction supervision were provided.

The clinic is a support and care facility for the children and adolescents (0-19 years of age) and will provide teaching, training and research facilities.



RELOCATION OF SHIMONI DPS & CORE PTC

NEWPLAN was contracted by Ministry of Education and Sports to provide consultancy services for the design, of the relocation of Shimoni Complex to newer premises. This included the design of the Demonstration Primary School, Primary Teachers’ College, and Staff Housing & proposed main entrance (image below) among other facilities.

The project covers 22,990 Sqm. and consists of:

- Administration and Classroom blocks,
- Kitchen block,
- Ablution block and VIP latrines
- Staff housing
- Support facilities i.e. sports field with football pitch, netball & basketball courts.



Proposed Block design of Shimoni complex



Proposed entrance to Shimoni complex



Consulting Engineers & Planners

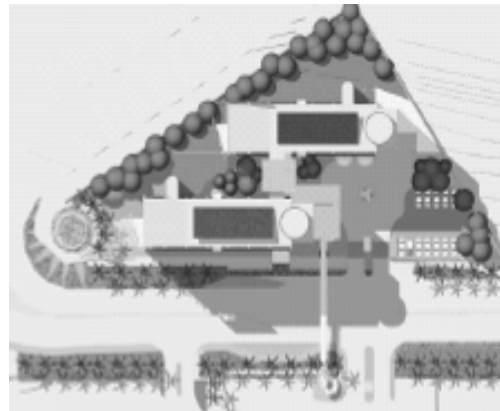

NEWPLAN Limited
Crusader House
1st floor, Plot 3 Portal Avenue
P.O. Box 7544, Kampala, Uganda

telephone: + 256 414 340243/4/5
fax: + 256 41 257 861
e-mail: info@newplan.ug
website: www.newplan.ug